

Activating and Applying PakSense XpressPDF™ Labels

STEP 1

Press the “start” button in the label’s lower left hand corner for 2 seconds. Lights will flash to confirm successful activation.

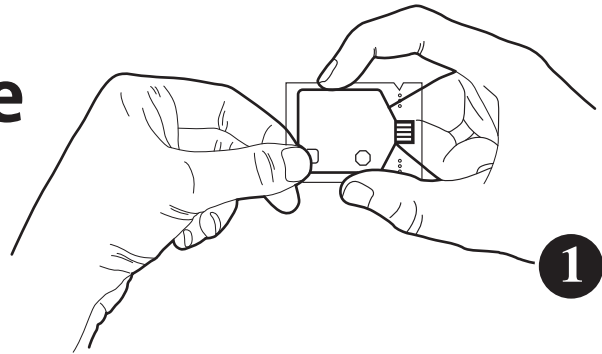

STEP 2

If adhering the XpressPDF label directly to product, peel plastic off of glue dot on back of label.

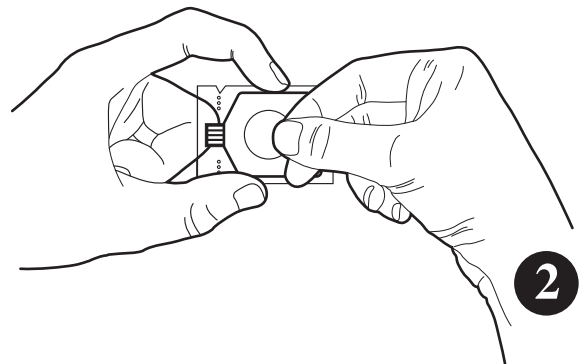

STEP 3

Adhere or place label next to product you will be monitoring. Ensure label is secure and will not move around during transit.

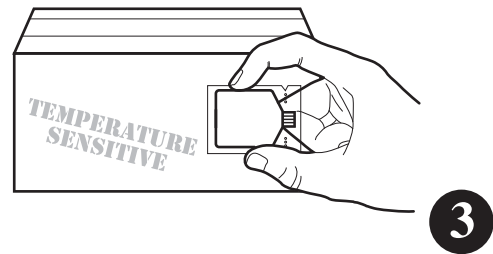

STEP 4

Once all product and packaging components are in the package, seal and ship.

STEP 5

Upon receipt of package, locate label, press and hold stop button at least 3 seconds to stop.

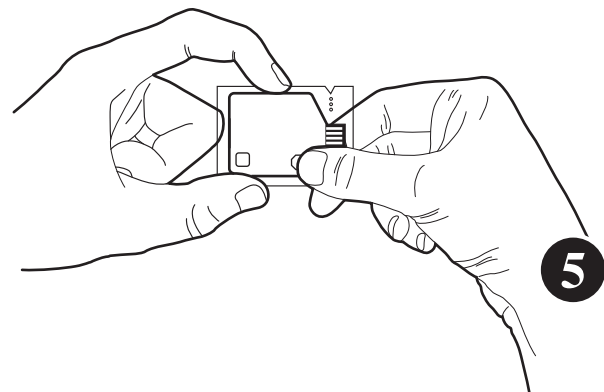

STEP 6

To download data plug into computer USB port.



PAKSENSE™
Sensory Solutions for Packaging

PakSense 9939 West Emerald • Boise, Idaho 83704 • 1+ 208-489-9010

CCT QS GUIDE/ 112011